



SCREW PIN SHACKLE

Model SH



Features

- RRC-271D Type IVA, Grade A Class 2.
- Shackles meet or exceed Federal Specification RRC-271D.
- Working Load Limit and Traceability codes shown as permanent marking on body and pin.
- Available in painted, galvanized.
- Special products engineering available to fit your special lifting, tie down and pulling needs.

Screw Pin Shackle

- Allows for many creative recoveries.
- Ideal for use with Straps & Chains.
- A MUST for every Gear Bag.
- From 1 to 35 ton.



757 S.E. 17 Th St.
Ft Lauderdale, FL 33316
(954) 367-6116
WWW.ACIHOIST.COM

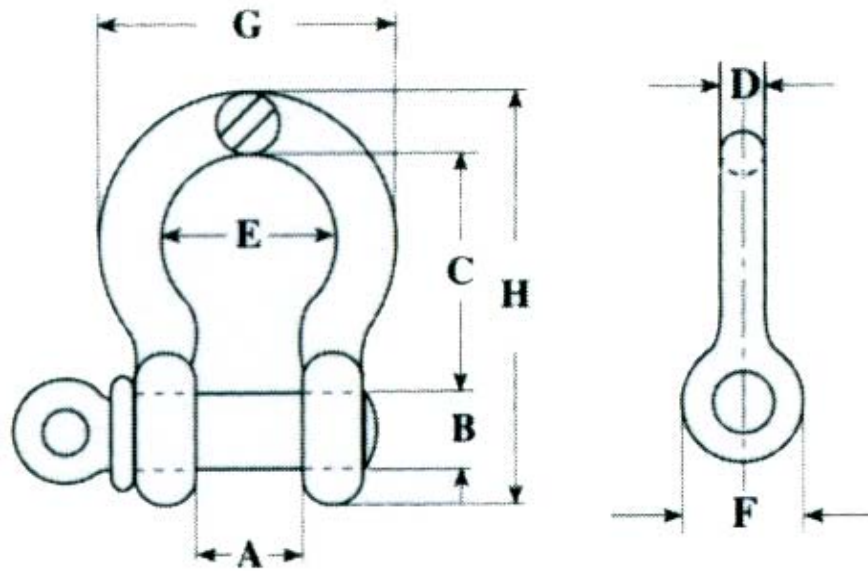

SCREW PIN SHACKLE SPECIFICATIONS

Model	SIZE (in)	WLL (Ton)	A (in)	B (in)	C (in)	D (in)	E (in)	F (in)	G (in)	H (in)	Net. Weight (lb)
SH-100	3/8	1.0	0.66	0.44	1.44	0.38	1.03	1.26	1.78	2.49	0.31
SH-200	1/2	2.0	0.81	0.63	1.88	0.50	1.31	1.19	2.31	3.28	0.73
SH-475	3/4	4.75	1.25	0.81	2.81	0.75	2.00	1.81	3.50	4.97	2.36
SH-950	1 1/8	9.5	1.77	1.44	4.25	1.16	2.91	2.69	5.16	7.47	7.41
SH-1700	1 1/2	17.0	2.38	2.03	5.75	1.54	3.88	3.63	6.88	10.0	17.20
SH-2500	1 3/4	25.0	2.87	1.97	7.0	n/a	5.0	n/a	n/a	n/a	27
SH-3500	2	35.0	3.23	2.24	7.76	2.00	5.75	3.00	9.50	12.5	42

WLL: Working load limit